

Axis Fence

Installation Guide

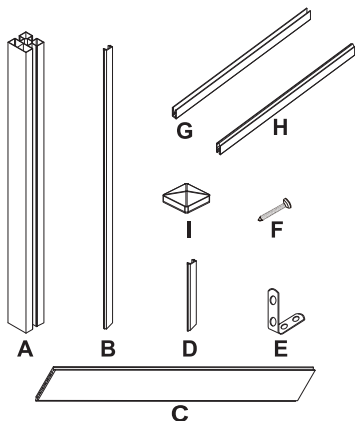
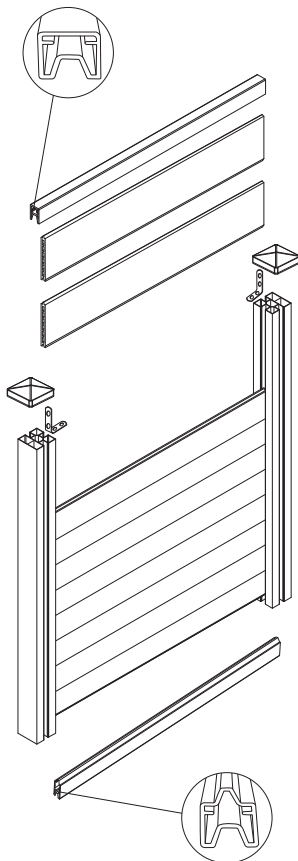

- 2 Alu Posts A
- 2 Alu Post Infills B
- 12 Panels C
- 2 Short Alu Post Infills D
- 4 Locking Brackets E
- 16 Screws F
- 1 Aluminum Top Rail G
- 1 Aluminum Bottom Rail H
- 2 Post Caps I

Post Installation - In Ground

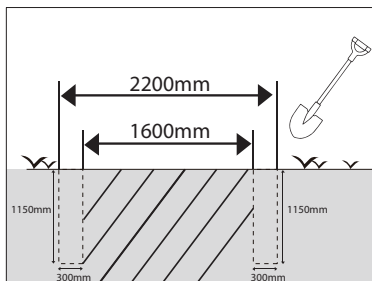

Use a shovel to dig a hole with 300x600mm minimum size. The hole should be spaced at 2200mm out-to-out distance and 1600mm internal to internal distance.

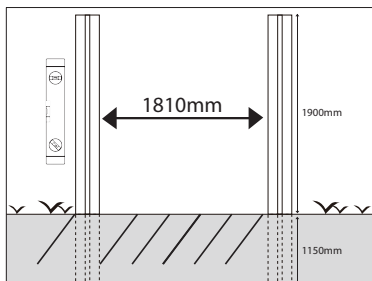

Insert the posts in the middle of the hole, using a spirit level. Make sure they are completely vertical and straight. The posts should be spaced at 1810mm internal to internal distance.

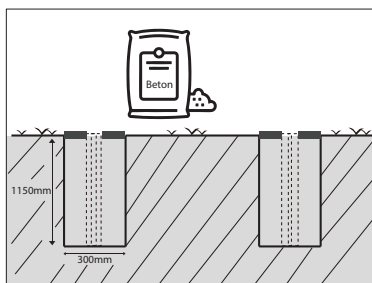

Pour the concrete into the hole until it's 600mm below the ground level. Fill the top of the hole with soil once the concrete is set.

Please Note:

Make sure to pour the concrete evenly around the post, and the hole fills completely.

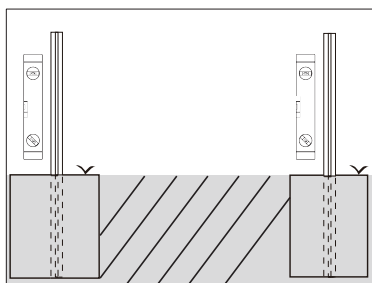

Use a spirit level and make sure the posts are completely vertical and straight again.

Fence Boards Installation

Step 1

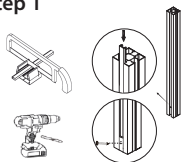

Cut the short post infill (D) in 3~5cm, insert it into the bottom of post and fix it with the screw (F).

Step 2

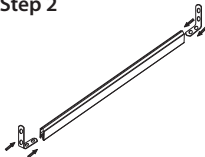

Insert the locking brackets (E) into the bottom rail (H).
Attention: The raised side must face upwards.

Step 3

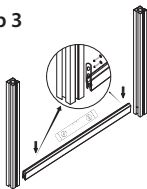

Put the bottom rail (H) over the short post infill. Attach the bottom rail between the posts (A) with one or two screws (F) per side.
Use the spirit level to check that it is installed in a straight position.

Step 4

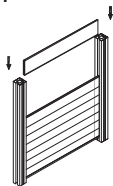

Put the fence panels (C) over the alu. bottom rail (H), total 12pcs fence panels.

Step 5

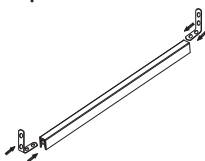

Insert the locking brackets (E) into the top rail (G) and fix it with screws (F).
Attention: The concave side must face downwards.

Step 6

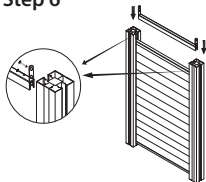

Attach the top rail (G) between the posts (A) with two screws (F) per side.

Step 7

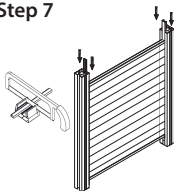

Cut the short post infill (D) to the appropriate size for the two inside sides of the Alu posts (A). Fill the sides with the cut post infills (D).

Step 8

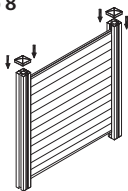

Finally, place the post caps (I) on the top of Alu posts (A) - done!

Step 9

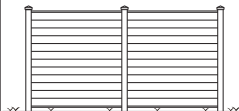

To continue assembling one or more add-on elements, follow steps 1 - 8 of the basic element - done!

Axis Fence

Installation Guide

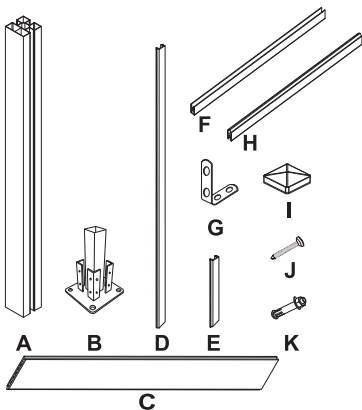
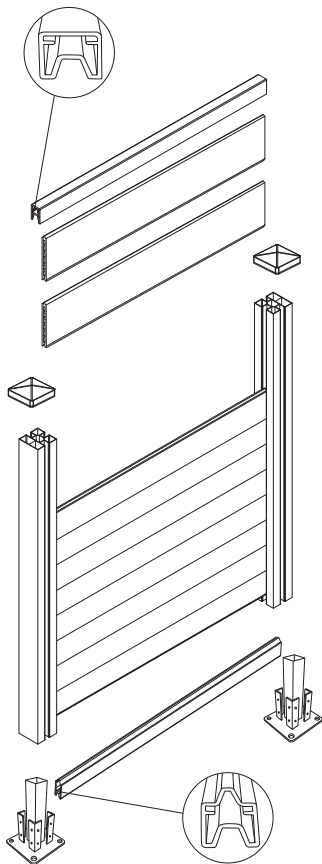

- 2 Alu Posts A
- 2 Metal Post Base B
- 12 Panels C
- 2 Alu Post Infills D
- 2 Short Alu Post Infills E
- 1 Aluminum Top Rail F
- 4 Locking Brackets G
- 1 Aluminum Bottom Rail H
- 2 Post Caps I
- 32 Screws J
- 8 Expansion screws K

Post Installation - Above Ground

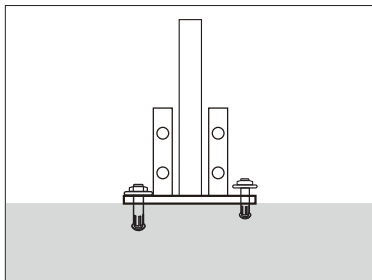

Check with your local government to determine if the fence requires a permit. This fence requires the use of expansion screws, please ensure that the installation area is solid enough before proceeding.

Use the expansion screws to secure the steel base to the ground and tighten the expansion screws.

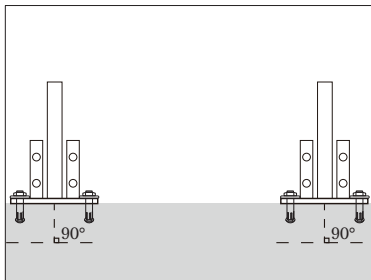

Make sure the steel base is 90 degree vertical to the ground.

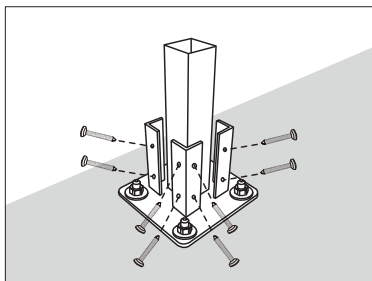

Fix with the screws.

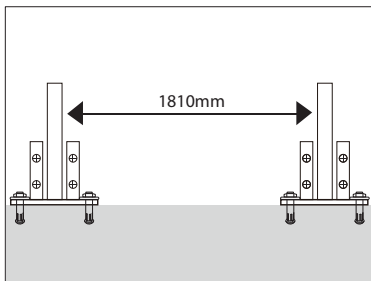

The posts should be spaced at 1810mm internal to internal distance.

Fence Boards Installation

Step 1

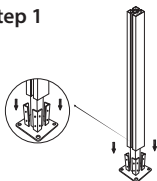

Put the post into the Metal Base.

Step 2

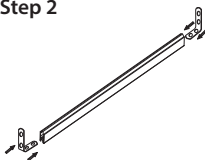

Insert the locking brackets (G) into the bottom rail (H).
Attention: The raised side must face upwards.

Step 3

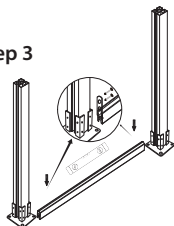

Put the bottom rail (H) over the short post infill. Attach the bottom rail between the posts (A) with one or two screws (J) per side.
Use the spirit level to check that it is installed in a straight position.

Step 4

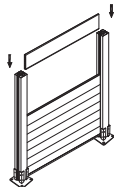

Put the fence panels (C) over the alu. bottom rail (H), total 12pcs fence panels.

Step 5

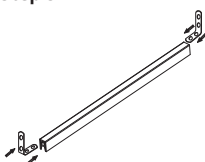

Insert the locking brackets (G) into the top rail (F) and fix it with screws (J).
Attention: The concave side must face downwards.

Step 6

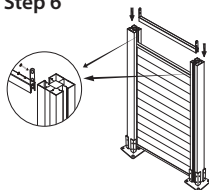

Attach the top rail (F) between the posts (A) with two screws (J) per side.

Step 7

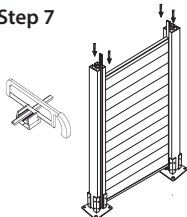

Cut the short post infill (E) to the appropriate size for the two inside sides of the Alu posts (A). Fill the sides with the cut post infills (E).

Step 8

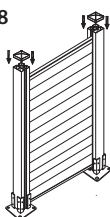

Finally, place the post caps (I) on the top of Alu posts (A) - done!

Step 9

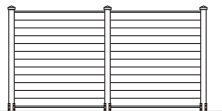

To continue assembling one or more add-on elements, follow steps 1 - 8 of the basic element - done!